

Test the VINYL you breathe[®]
EVORICH
Since 2003...



HERF ISOCORE[®]

- INSTALLATION INSTRUCTIONS

DISCLAIMER: ACTUAL METHOD OF INSTALLATION MAY VARY
DEPENDING ON TERRITORIES OF INSTALLATION.

GENERAL INFORMATION

HERF ISOCORE® combines simple drop-and-lock installation featuring innovative ISOCORE® Technology™; a waterproof, strong, and stable core that offers outstanding performance, durability and longevity. The planks even have a sound-mitigating underlayment to help minimize sound travel.

The ISOCORE® Layer features an engineered closed-cell PVC structural core that is 100% waterproof, rigid and dimensionally stable. This means that the planks are resistant to warping, expansion, contraction and also helps hide subfloor imperfections.

HERF ISOCORE® is lightweight and easy to install with simple drop-and-lock installation. The DropLock 100 end joints increase installation speed and align with the top surfaces of adjoining planks.

HERF ISOCORE® Flooring features luxurious embossing for a natural look and feel. HERF ISOCORE® can be installed over existing floors such as natural wood, concrete, vinyl, linoleum, and even ceramic, saving you time and money! (See subfloor preparation on page 3.)

HERF ISOCORE® is WATERPROOF, so it can be installed in areas that have been "off-limits" for traditional plank flooring and laminate products, such as basements and bathrooms. HERF ISOCORE® is not meant to be a moisture barrier. It will not prevent damages from flooding, excessive moisture, alkalis or conditions from hydrostatic pressure in the subfloor. (See subfloor preparation section on page 3.)

HERF ISOCORE® has a Ceramic Bead coating for added wear and stain resistance. Plus, HERF ISOCORE® is treated with Ultra-Fresh* to inhibit the growth of odor and stain-causing mold and mildew on the attached underlayment and top surface layer of the flooring.

HERF ISOCORE® is comfortable under foot, warmer in the winter and cooler in the summer than other hard surface flooring materials.

Follow the instructions for installation in the next section and you will be enjoying your beautiful new floor in just a few hours.

window treatments or UV tinting on windows. HERF ISOCORE® is not intended for use on stairs or vertical surfaces. Do not glue, nail, screw or fasten to substrate. Install cabinetry, island and peninsula counters, vanities, tubs, and showers first. Then, install HERF ISOCORE® around them. For more information on installation specifications, please see the chart on right.

***Failure to follow these guidelines will void the warranty.**

3. Evo HERF®'s condition prior to installation

The Installation of HERF ISOCORE® does not require acclimation. However, we recommend installation in rooms with temperatures between 13°C - 32°C. Products should be stored horizontally in a dry area away from direct sunlight. Do not leave next to heat or cooling ducts. Ensure that all trades have been completed to eliminate dry wall dust, paints, etc.

NOTE: If HERF ISOCORE® is subjected to extreme hot or cold temperatures prior to installation, it may make the product more difficult to install or cause damages to the locking system. Allow the product to store under room temperature before installation.

HERF ISOCORE® INSTALLATION INSTRUCTIONS

1. Tools needed

- Utility knife & straight edge
- Measuring tape
- Soft-faced or rubber mallet
- Shears for cutting around irregular shaped objects (pipes)
- 6mm spacers
- Pencil
- Tapping Block

2. Planks needed to complete your project

Measure the length & width of your room. If the room is equipped with alcoves or offsets, measure these separately. This will give you the square meters of the room. Purchase a minimum of 10% extra to cover mistakes, trimming and for future needs and / or replacement. Most installations require about 10% overage. However, this can vary depending upon the room size and layout.

HELPFUL HINT # 1: For best results, it is important to purchase product (cases) from the same RUN # (dye lot) whenever possible. Always install planks from 3 or 4 cases at one time. Different run numbers can have shade variations. Every case of HERF ISOCORE® has the run number printed on the ends of the case. Run number example: 30.08.2009. If you do have more than one run number, we recommend you to install planks from 3 or 4 different cases from different run numbers at one time and randomly mix them into the installation as you go. This will ensure a more natural- looking floor.

CAUTION: Do not install HERF ISOCORE® over carpet or any foam underlayment. This product is not suitable for any outside use, sunrooms/ solariums, saunas, seasonal porches, camping trailers, boats, RVs or rooms that have a potential of flooding. Exposure to long term direct sunlight can cause damage to your floor. Failure to properly shade or UV tint windows can discolour, fade, or buckle HERF ISOCORE®. Use

HERF ISOCORE® INSTALLATION:

Connection Type	DropLock 100 End Joints (Click)
Free Floating Floor	Yes. DO NOT screw or nail moldings, transitions, cabinetry or vents through ANY HERF® flooring
Temp range before, during and after installation:	13° C to 32° C. After installation temps should stay between 10° C to 35° C
Interior Product Only	Yes. See limitations/exclusions below
Storage	Horizontally
Dye Lots	Yes. Install from a minimum of 3 to 4 different boxes and dye lots at one time. See page 2 for more information
Expansion Space	Yes. For room perimeters and fixed objects please leave 6mm optimum space
Floor Flatness Tolerances	6mm over 3.05m. Use floor leveler when exceeding tolerance
Special Tools Required	Yes. Utility knife and straight edge, measuring tape, soft-faced or rubber mallet (to tap and lock plank seams), shears, tapping block, pencil and 6mm spacers
Hand Roller Required	No
34 kg. min. Floor Roller	No
Moisture Reading Guidelines: OVER CONCRETE Scale 0% to 4% Scale 5% to 6% Scale over 6%	Based on Tramex Concrete Moisture Encounter Plus Meter (scale 0 to 6%) No moisture barrier Use 150 micron poly moisture barrier Seal concrete with waterproofing agent
Moisture Reading Guidelines: OVER WOOD Scale 0 to 13%	Never use 6 mil poly over wooden subfloors OK to install. Do not install above 13% moisture levels
Primer Over Wooden Subfloors	No
Basement Proofer over Concrete	No
Moisture Barrier (6 mil poly)	Yes above 5% only
Installs Over Radiant Flooring	Yes. Electric or hydronic approved — best practice recessed min 12.7mm below finished floor. Do not turn thermostat above 30°C
Suspended Wood Floors	Yes. 457mm minimum well ventilated crawl space Use moisture barrier over ground/dirt Especially for mobile home installations
Foam/Cushioned Underlayment	No. Voids warranty if used in any application
Approved Subfloors - See Below	Must be smooth, solid, dry and no deflection
Wood	Yes. Solid, engineered, parquet, but not woods installed over concrete.
Plywood	Yes. OSB & particleboard are approved for HERF® products only . Luan is approved for all products.
Vinyl	Yes. install over 1 layer only: Vinyl, linoleum, VCT, LVT, and Peel & Stick
Concrete	Yes. Sealed, unsealed, poured in place gypsum. On grade or below grade (see moisture guidelines)
Plank (Stone)	Yes. Ceramic, Terrazzo, stone plank (grout lines of less than 6mm is optimum)
Dricore xl	Yes
Subfloors Not Approved	Carpet (any type), foam underlayment, cushioned back vinyl, rubber, cork, laminates, free floating floors
Subfloor-Approved Products	Primer - Custom Building Products Level Quik Primer Basement Proofer - CBP (Custom Building Products), RedGard Waterproofing & Crack Prevention Floor Leveler - CBP Level Quik
Limitations/Exclusions	These types of installations will NOT be covered under warranty: All exterior installations & seasonal porches, boats/campers/RVs, sunrooms/solariums, non-temperature-controlled rooms or homes
Steam Cleaner	DO NOT USE
Vertical Surfaces & Staircases	Not covered under warranty. Can be done using high-quality construction adhesive. Product not intended for this usage
Limited Warranties	Lifetime residential, 5-year full commercial

INSTALLING HERF ISOCORE®:

NOTE: Before installation, carefully inspect each plank for visual defects, damage, and sheen under adequate lighting (daylight is best). Do NOT install damaged or defective material

1. Lay a row of loose planks (Figure 1) without securing them to each other first to determine if you need to adjust the length of the first plank to avoid a small piece of less than 300mm on the opposite wall from where you started. Or, measure the length of the room and divide by 1210mm (length of one plank).

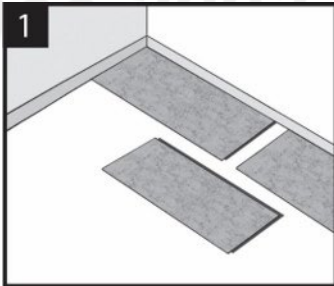

Figure 1

2. Installation should start in a corner (left hand) and proceed from the wall with the tongue facing the wall. Allow a minimum gap of 6mm for subfloor movement which can be covered by molding (Figure 2). Set 6mm in spacers to create the required expansion space.

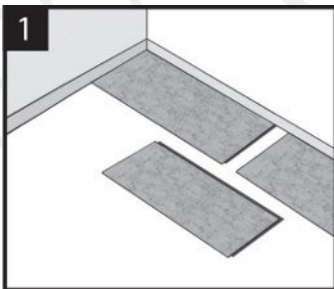

Figure 2

3. When laying the first row in a straight line, interlock the short ends by inserting the tongue into the grooves at an angle of approx. 10 to 20 degrees (Figure 3). Install each sequential plank on the short end

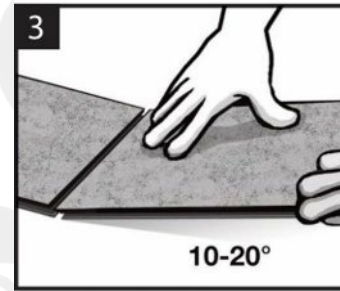

Figure 3

4. When installing HERF ISOCORE® planks, it is strongly recommended to stagger the rows so that the short edge 190mm seams are not in a straight uniform line. We recommend the staggered 3'-2'-1' method. However you may want to try other "patterns" of planks to suit your taste. Maintain a minimum 300mm end-joint stagger from row-to-row throughout the entire installation.

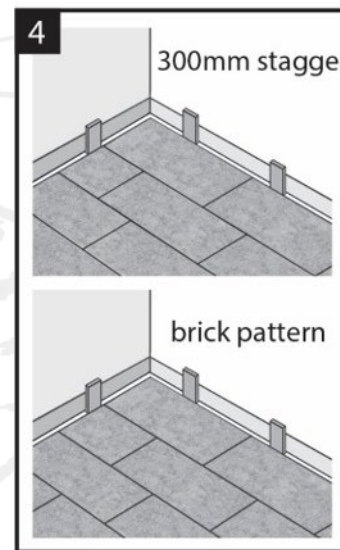

Figure 4

KEY INSTALLATION TIPS

Interior Environmental Conditions	13°C to 32°C & 40% to 60% relative humidity
Acclimation for residential use	not required
Acclimation for commercial use	acclimate for 48 hours (between 13°C to 32°C)
Subfloor Flatness Tolerances	6.35mm over 3.05m or 3.18mm over 1.83m
Vapour Barrier (6 mil poly)	not required
Underlayment Pad Required	NO – HERF ISOCORE® includes pre-attached pad
Radiant Heated Floors	Must be cast 12.7mm below subfloor. NO electric mats
Perimeter Expansion	Space requirement of 6.35mm gap around the walls, for heavy fixed objects (cabinetry)
Glue Down Installation	NOT RECOMMENDED – Voids the warranty

5. Start the second row with the plank cut at two-thirds for the staggered 3'-2'-1' method, or randomly staggered so the plank is cut no shorter than 300mm. (Figure 5). Simply measure and mark the plank. Then using a straight edge, make several passes with a utility knife over the decorative side of the plank. Turn the plank over and score the under pad of the plank at the same place and then snap.

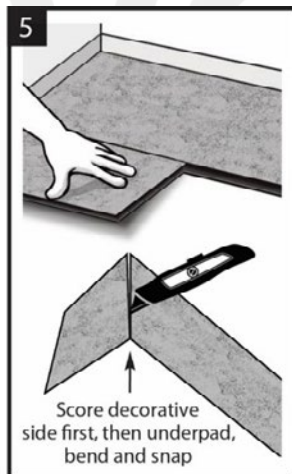

Figure 5

6. Attach the first plank of Row 2 by connecting the long side to the first row. Maintain your 6mm expansion gap. Then, attach the second plank by connecting the long side to the first row and sliding it up to the short end of the first plank. After that drop and lock. See Figure 6.

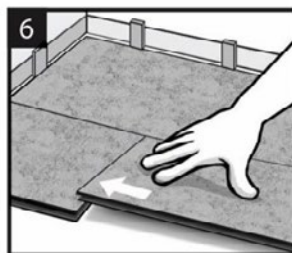

Figure 6

7. When cutting a plank to start a row, you will need to cut off the end with the groove. The remaining piece can then be used on the opposite side of the room, at the end of that row if layout permits. See Figure 7.

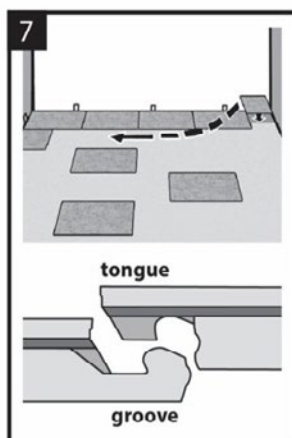

Figure 7

8. Fitting around irregular objects is no problem. Simply make a pattern out of heavy paper to fit around pipes or irregular objects. Place the pattern upon the plank and trace (Figure 8). Cut along trace lines using a utility knife or sharp shears, and lay the plank. Be sure to leave a minimum of 6mm expansion space around all fixed objects, cabinetry, and metal door jambs. Undercut wooden door jambs. Fill any expansion spaces around potentially wet areas such as refrigerators, tubs, and appliances with premium waterproof 100% silicone.

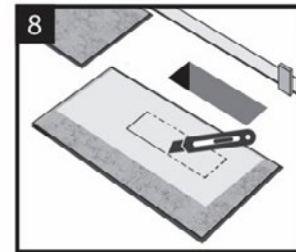

Figure 8

NOTE: Rooms larger than 150m² (15m x 10m) require the use of coordinating T-molding transitions. Doorways and archways less than 1.22m wide require the use of T-molding transitions.

HELPFUL HINT #2: Save any leftover planks or planks. Do not discard as they are colour-matched (dye lot) to your floor. They can be used for replacement in the event that you need to replace a plank or planks in the future.

CAUTION AND MISCELLANEOUS

If you have any problems or questions, please call our Customer Help Line at +65 6348 7333

Are you getting the idea that this product was created by people who love their job? Well, the answer to that question is "YES WE DO!" We will continue to enhance HERF ISOCORE®'s experience with added installation features as well as innovative products and exciting patterns that meet the needs of our customers.

Thank you for buying **HERF ISOCORE®**, and be sure to share with us your experience in using the product. Simply write or email to:

Evorich Global Support:
16 Tampines Street 92
Singapore 528873
feedback@evorich.com.sg

Test the VINYL you breathe[®]
EVORICH[®]
 Since 2003 ...



Evorich Manufacturing Pte Ltd



National Wood Flooring Association



A ROTARY SINGAPORE ASME AWARD
 EYA-Established Entrepreneur 2016



Represented Singapore in ASEAN-Japan Young Entrepreneur Forum



Winner, SPBA - Established Brands

Building and Construction Authority
 Registered Contractor

w: www.EVORICH.com.sg | e: sales@evorich.com.sg
 T: +65 6348 7333 (16 lines) | +65 8795 2118 WhatsApp | F: +65 6342 9331

EVORICH R&D Production . Experience Exhibit (Cheques Receiving Centre):
 16 Tampines Street 92 Singapore 528873

EVORICH Concept Sales Gallery
 Floors . Decks . Walls . Ceilings:
 1 Tampines North Drive 1, #02-38 T-Space EVORICH Block, Singapore 528559
 (In between IKEA, Giant & Courts)

EVORICH Curated Studios
 Floors . Decks . Walls . Ceilings:
 10 Jln Kilang, Bukit Merah Enterprise Centre #02-02 Singapore 159410
 (Entire Stretch of Level 2 facing the main road)

EVORICH Floors . Deck . Wall Training Academy:
 27 Kim Chuan Terrace Singapore 537045

EVORICH WhatsApp



SAVOUR Me!