

Test the VINYL you breathe®  
**EVORICH**  
Since 2003...



**HIGH END RESILIENT FLOOR**

# **Evo HERF™**

**DESIGNED BY EVORICH IN SINGAPORE**

- INSTALLATION INSTRUCTIONS**
- CARE AND MAINTENANCE**

DISCLAIMER: ACTUAL METHOD OF INSTALLATION MAY VARY  
DEPENDING ON TERRITORIES OF INSTALLATION.

## GENERAL INFORMATION

### What makes Evo HERF® so unique and revolutionary?

Evo HERF® is the ultimate “do-it-yourself” flooring product. It’s just that easy to install.

No messy adhesives or glue is necessary.

Because of Evo HERF®’s flexibility, the planks can be installed over uneven subfloors or existing floors such as natural wood, concrete, vinyl, linoleum, and even ceramic.

#### **Saving you time and money!**

Evo HERF® looks and feels like wood, it’s WATERPROOF, so it can be installed in moisture-prone areas that have been “off-limits” for traditional wood flooring and laminate products, like basements and bathrooms. See subfloor preparation section.

#### **Evo HERF® has a CBT (Ceramic Bead Technology) coating for added wear and durability!**

Each Evo HERF® plank locks to another plank. It is not glued to your sub-floor, but using the interlocking strip. It’s free floating. To cut a plank, simply score and snap.

Evo HERF® is quiet and warm underfoot.

Follow the instructions for installation in the next section and you will be enjoying your beautiful new floor in just a few hours.

## Evo HERF® INSTALLATION INSTRUCTIONS

### 1. Tools needed

- Utility knife & straight edge
- Measuring tape
- Shears for cutting around irregular
- Shaped objects (pipes)
- 1/8” spacers

### 2. Planks needed to complete your project

Measure the length and width of your room.

If the room has alcoves or offsets, measure these separately. This will give you the square footage of the room. Purchase a minimum of 10% extra to cover mistakes, trimming and for future needs or replacement. Most installations require about 10% coverage. However, this can vary depending on the room size and layout.

Evo HERF® comes in 48” x 7.5” planks or 2.5 square feet per plank. 8 planks per case = 20 square feet per case.

So, if your room is 10’ x 10’ or 100 sq.ft., we would recommend you to purchase 6 cases (120 sq.ft.).

**HELPFUL HINT # 1:** For best results, it is important to purchase the product (cases) from the same RUN # (dye lot). Different run #s can have shade variations. Every case of Evo HERF® has the run # printed on the ends of the case. Run # example: 30.08.2009. If you do have more than one run # we highly recommend you to install planks from 4 or 5 different cases from different run #s at one time and randomly mix them into the installation as you go. This will ensure a more natural looking floor.

**CAUTION:** Do not install Evo HERF® over carpet or any foam underlayment. This product is not suitable for outdoor use, sunrooms/solariums, saunas or rooms that have the potential of flooding. We also highly recommend you do not install in rooms or homes that are not temperature controlled. Exposure to long-term direct sunlight can cause damage to your floor.

### 3. Evo HERF®’s condition prior to installation

You MUST store Evo HERF® horizontally in the room of installation for 24 hours prior to installation at room temperature. DO NOT remove the planks from the case during this acclimation period! Maintain this temperature during installation as well.

**HELPFUL HINT # 2:** When installing Evo HERF®, be sure to keep dust, dirt or foreign particles away from the Locking Strip. The cleaner the Locking Strip remains, the better the bond between planks. Evo HERF® planks are best kept in the box until you are ready to install them. A protective sheet paper has been placed between each plank insuring the Locking Strip remains clean and ready to use.

### 4. Subfloor preparation:

The subfloor surface must be smooth, flat, dry, clean and solid. Carpet staples or adhesive residue must be removed to ensure proper installation.

Subfloors should be flat within a tolerance of 1/8” (3mm) over a span of 4 feet. Any unevenness over 1/8” (3mm) must be sanded down or filled with a floor leveller. Voids or humps in the subfloor will prevent Evo HERF® from locking properly.

Subfloors must be carefully checked for moisture problems. Evo HERF® is waterproof. It is NOT a water-proofer. Any moisture problems will need to be addressed prior to installation. New concrete floors need to cure for a minimum of 60 days.

**HELPFUL HINT # 3:** If laying Evo HERF® over existing ceramic tile, it will be necessary to skim coat the grout lines with a floor leveller. If you install Evo HERF® over an existing floor that has an embossing or grout line on it, you must skim coat with a floor leveller if the embossing or grout line is greater than 1/8” – (3mm).

If you have old, ugly vinyl floors and don’t want to pay for an expensive removal and remediating job, Evo HERF® is the perfect answer. Any loose or damaged tiles should be patched prior to installing Evo HERF® over the old floor. Never sand old vinyl floors from any floor manufacturer, if you think the floor maybe 20 years old.

### 5. Installing Evo HERF®:

**Anyone can do it!**

**HELPFUL HINT # 4:** Before laying out the floor, check the wall you are starting from and make sure it is square to the opposite wall. Simply measure the room from opposite ends of the wall to the far wall. If the measurements are different you can make adjustments on the first row of Evo HERF® by scribing the plank.

1. Lay a row of loose planks without securing them to each other first to determine if you need to adjust the length of the first plank to avoid a small piece of less than 12” on the opposite wall from where you started or measure the length of the room and divide by 48” (length of one plank). If the remainder is less than 12”, calculate ½ of the remainder and trim this amount off the first plank. The last plank should be the same length as the first one. To cut a plank, simply measure and mark the plank, then using a straight edge and utility knife, simply score the plank and snap. It’s that easy!

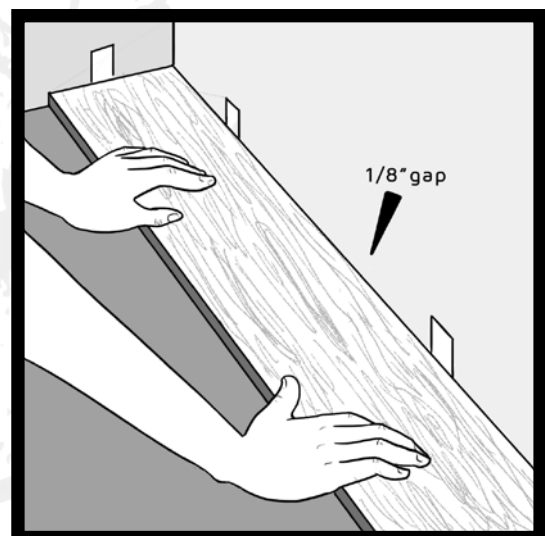

Figure 1

2. Installation should start in a corner (left hand) and proceed from the wall with the tongue facing out from the wall (Figure 1). Allow a minimum gap of 1/8” (2-3mm) for subfloor movement or product

expansion, which should be covered by moulding.

3. When laying the first row in a straight line interlock the short ends by inserting the tongue into the grooves at an angle of approx. 15 to 20 degrees. Install each sequential plank on the short end (7.5") and be sure to line up evenly. This is very important for a good installation.

4. Be sure to keep the seams tight. You will feel and hear the click when locking the planks together to create a tight seam. There should be no gap visible between planks.

If your seam appears to be not tight, you can immediately pull apart the planks and reapply it. Slowly lift the top plank away from the bottom plank and simply reapply them - repeating Step #3. Be careful not to pull the planks apart too fast or you will rip or damage the Locking Strip.

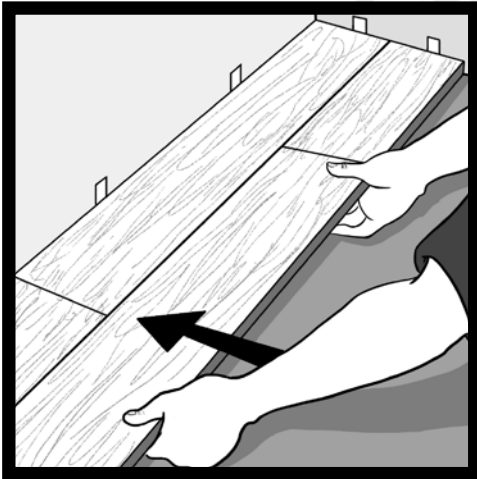

Figure 2

5. When installing Evo HERF®, it is strongly recommended to stagger the rows so that short edge (7.5") seams are not in a straight uniform line. We recommend the staggered random method 3'-2'-1' (Figure 2). However, you may want to try other "patterns" of planks to suit your taste. Evo HERF® can be installed with endless possibilities - your only limitation is your own imagination!

6. To start the second row with the plank cut at about 2/3 length (32"). Measure and mark the plank, then use a straight edge and utility knife to score the plank and snap.

7. Interlock the plank tightly against the first row (long side) again at a 15-20 degree angle. The next plank, interlock the short side first, leave it slightly away from the long side and then slide into the long side.

**HELPFUL HINT # 5:** When cutting Evo HERF® for length, be sure to always cut the short side of the plank with the groove edge. The remaining piece can then be used on the opposite side of the room, at the end of that row (Figure 3) if layout permits.

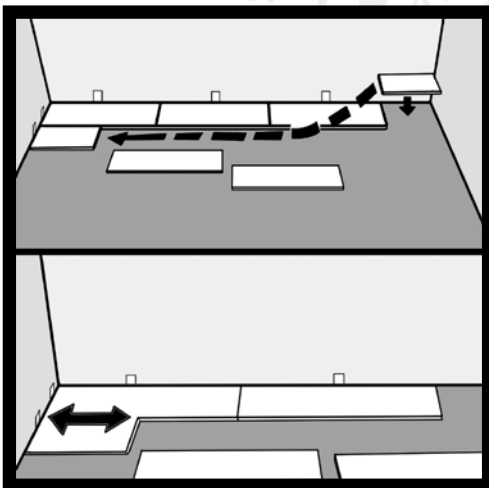

Figure 3

8. Start the third row with the plank cut at 1/3 of a length (16"). Again the remaining piece can be used at the opposite end of the row if the layout of the room permits.

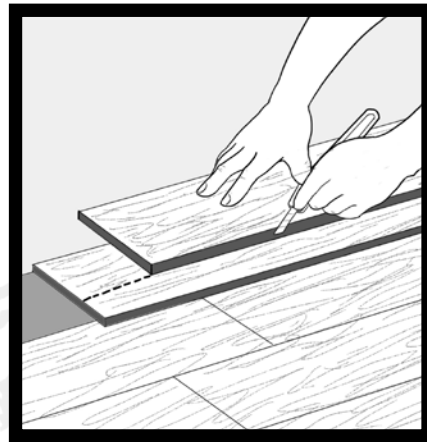

Figure 4

9. Continue this pattern for the remainder of the rows to be installed. Always place the cut end of the first plank against the wall (Figure 4).

10. Fitting around irregular objects, no problem. Simply make a pattern out of heavy paper to fit around pipes or irregular objects. Place the pattern upon the plank and trace. Cut along trace lines using a utility knife or heavy duty scissors, and lay the plank. Be sure to leave a minimum of 1/8" expansion space around all fixed objects, floor vents and door frames.

11. The beauty of Evo HERF® is the ease of installing the opposite way. You can install from both sides of the plank. This allows you to start in one room and continue through a doorway to another room with the same pattern and continue installing the floor forwards or backwards.

**HELPFUL HINT # 6:** Be sure to keep some spare Evo HERF® in case there is an unforeseen need of replacement. If you need to replace a plank of Evo HERF®, simply take a utility knife and cut the bad plank out along the long side of the plank only and lift out from the place. Then take a spare plank and cut the tongue and groove off of the long side of the replacement plank only. Leave the tongue and groove on the short side of the plank. Then simply fit into place and lock the two short ends into place.

## CARE AND MAINTENANCE

Congratulations! You have just installed Evo HERF® from Evorich Flooring. Your new resilient floor was produced under the highest quality standards and will provide you with a lifetime of enjoyment. Although Evo HERF® is one of the easiest floors to maintain, please follow the recommendations in this guide to retain the fresh look and protect the factory finish.

### Preventive maintenance:

1. Use NON-RUBBER protective mats in front of any doors leading to the outside. This helps to get the sand and grit from getting on to your floors. Gritty sand is the worst enemy of any floor covering.
2. Install proper floor protectors (felt preferred) on all furniture legs used on resilient flooring. Protectors will allow chairs to move easily over the floor without scuffing or scratching. Clean protectors on a regular basis to remove any grit that may have become embedded on the bottom of the furniture leg. For any swivelled-type office chair and other rolling furniture, please install 2" wide non-staining flat casters. Do not use rubber casters.
3. To keep your floor looking its best, dust mop or vacuum your floor at least twice a week. Do it more often on floors with heavy traffic. Do not use household dust cleaner of any kind as this may cause the floor to become slick or damage the finish. Simply sweep the floor as often as needed.
4. Do not allow pets with unclipped nails to damage your Evo HERF®. It may result in severe scratching to the surface. The same is true for any

high heeled shoes that do not have proper tips on the heels.

5. Avoid exposure to direct sunlight for prolonged periods of time. During peak sunlight hours, use drapes or blinds to minimize the direct sunlight on Evo HERF®. Most types of flooring will be affected by continuous strong sunlight. To avoid an uneven appearance, please consider relocations of any area rugs from time to time. In addition, excessive temperatures are not good for resilient floors. Natural ventilation or intermittent air conditioning in vacant homes should be considered. Long-term continuous inside temperatures over 95°C degrees along with strong direct sunlight will damage your Evo HERF® and cause the installation to fail.

**HELPFUL HINT #7:** To avoid yellowing from asphalt driveways or parking lots, always use doormats at entranceways. It is a good idea to use a hard surface floor attachment when vacuuming your Evo HERF®.

#### Regular maintenance:

1. Food spills should be cleaned up as rapidly as possible with a quality liquid vinyl cleaner (brand recommended by EVORICH®). Make sure the cleaner you choose is an all-purpose liquid cleaner that is NONABRASIVE. We do not recommend powdered cleaners, oil soaps, dishwashing detergents, or other dusting products. Try to use a nonrinsing, biodegradable cleaner that leaves no residue or haze and requires no rinsing after application.

2. Shoe marks and scuffs can be easily removed using a spot application of the vinyl cleaner recommended by EVORICH® and a green Scotch Brite pad.

3. Regular household dirt can be cleaned with the vinyl cleaner recommended by EVORICH® applied as indicated on the product's label. Some hand wiping may be required to remove tough spots and spills. Always sweep or vacuum your Evo HERF® before cleaning so that all loose dirt and particles are removed. For best results, do not use combination of cleaner/finish products.

4. Do NOT WAX YOUR Evo HERF®! The surface of your floor is very dense and non-porous; this prevents wax from penetrating and thus will build up and lead to yellowing and dirt collection. The same non-porous feature also provides all the protection against wear and staining that you will need. Use only vinyl cleaner recommended by EVORICH® for heavy wear when you have experienced some loss of the original appearance over time. Your Evo HERF® has been designed to be very easy to maintain, but you may prefer to add an occasional coat of the vinyl cleaner recommended by EVORICH® to renew and protect your floor.

5. If your floor has been exposed to excessive amounts of water due to flooding, don't panic, Evo HERF® is waterproof! Simply remove the water as quickly as possible with a Wet-Vac or other device and ventilate the room. A dehumidifier should be promptly turned on in the room to reduce the moisture levels back to normal. Do not dry the room below the normal moisture level that was set previously.

6. If accidental deep scratches appear on your floor then it might be necessary to replace such damaged tiles. Remember HELPFUL HINT #3, please refer to this section for replacing a plank of Evo HERF®.

7. If scratches are fine and the result of normal household use, then it is recommended to clean them with one or two coats of the quality liquid vinyl cleaner (brand recommended by EVORICH®).

#### First aid for your Evo HERF®

1. You may remove chewing gum, adhesive, crayon, candle wax, and similar types of substances by applying ice until it becomes brittle enough to crumble off. The residue may be removed with mineral spirits.

2. Extra deep heel marks, caster marks, etc.: rub with green Scotch Brite pad dampened with a vinyl cleaner recommended by EVORICH®.

3. For moderate to heavy stains caused by long-standing water or other non-dye liquids: Rub with a vinyl cleaner recommended by EVORICH®.

4. For dark spots caused by ink or other chemicals, clean the spot as per #2 above. If not successful, then the affected plank should be replaced as per HELPFUL HINT #6 of the "Installing Evo HERF®" section.

5. Animal and diaper stains should be treated the same as #3 above.

6. Cigarette burns if not deep, then procedure #2 above should work. If, however, they are very deep then the affected plank should be replaced with reference to HELPFUL HINT #6 of the "Installing Evo HERF®" section.

If you have any questions or concerns about caring for your Evo HERF®, please contact Evorich Flooring Group at +65 6348 7333 or check out our website at [www.evorich.com.sg](http://www.evorich.com.sg). You can also email us directly at [feedback@evorich.com.sg](mailto:feedback@evorich.com.sg).

#### Reminders!

1. Retain your Evorich Flooring sales receipt.
2. Keep records of the style and run number of your Evo HERF® planks. This appears on the outside of the carton alongside the barcode.

## STYLE of Evo HERF®:

---

### Run numbers:

---

## CAUTION AND MISCELLANEOUS

If you have any problems or questions, please call our Customer Help Line at +65 6348 7333

**IMPORTANT NOTE:** Room temperature when installing **Evo HERF®**. Please make sure your thermostat is set above 60°F and below 85°F when installing Evo HERF®. Room temperature is important!

Are you getting the idea that this product was created by people who love their job? Well, the answer to that question is "YES WE DO!" We will continue to enhance Evo HERF®'s experience with added installation features as well as innovative products and exciting patterns that meet the needs of our customers.

Thank you for buying **Evo HERF®**, and be sure to share with us your experience in using the product. Simply write or email to:

**Evorich Global Support:**  
16 Tampines Street 92  
Singapore 528873  
[feedback@evorich.com.sg](mailto:feedback@evorich.com.sg)

Test the VINYL you breathe <sup>®</sup>  
**EVORICH**  
 Since 2003 . . .



Evorich Manufacturing Pte Ltd



A ROTARY SINGAPORE ASME AWARD  
 EYA-Established Entrepreneur 2016



Represented Singapore in  
 ASEAN-Japan  
 Young Entrepreneur Forum



Since 1932  
 Singapore Manufacturer



Winner, SPBA - Established Brands



w: [www.EVORICH.com.sg](http://www.EVORICH.com.sg) | e: [sales@evorich.com.sg](mailto:sales@evorich.com.sg)  
 T: +65 6348 7333 (16 lines) | +65 8795 2118 WhatsApp | F: +65 6342 9331

**EVORICH R&D Production . Experience Exhibit (Cheques Receiving Centre):**  
 16 Tampines Street 92 Singapore 528873

**EVORICH Concept Sales Gallery**  
 Floors . Decks . Walls . Ceilings:  
 1 Tampines North Drive 1, #02-38 T-Space EVORICH Block, Singapore 528559  
 (In between IKEA, Giant & Courts)

**EVORICH Curated Studios**  
 Floors . Decks . Walls . Ceilings:  
 10 Jln Kilang, Bukit Merah Enterprise Centre #02-02 Singapore 159410  
 (Entire Stretch of Level 2 facing the main road)

**EVORICH Floors . Deck . Wall Training Academy:**  
 27 Kim Chuan Terrace Singapore 537045

EVORICH WhatsApp



SAVOUR Me!