

EVORICH[®]



HIGH END RESILIENT FLOOR

HERF[®]

HERRINGBONE

DESIGNED BY EVORICH IN SINGAPORE

INSTALLATION INSTRUCTIONS

DISCLAIMER: ACTUAL METHOD OF INSTALLATION MAY VARY
DEPENDING ON TERRITORIES OF INSTALLATION.

HERF HERRINGBONE® INSTALLATION INSTRUCTIONS

NOTE: Separate HERF Herringbone® A and B panels (as shown in **Figure 1**) into 2 separate stacks before starting the installation. Check both panels for any transport damage before starting. It is best for the HERF Herringbone® panels to be stored at site 24 hours before installation.

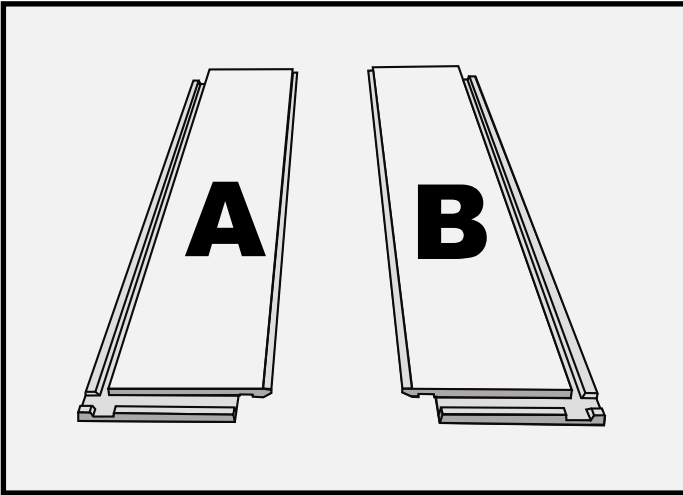

Figure 1

1. Subfloor Preparation:

Clean the floor prior to installation by sweeping / vacuuming.

2. Installing HERF Herringbone®:

Step 1: Start the installation on the left side of a wall. Lay an A panel on the floor with its long side facing the wall and place it at an angle of 45 degrees (**Figure 2**). The distance between the left wall and nearest point of the A panel must be less than the longer side of one HERF Herringbone® panel.

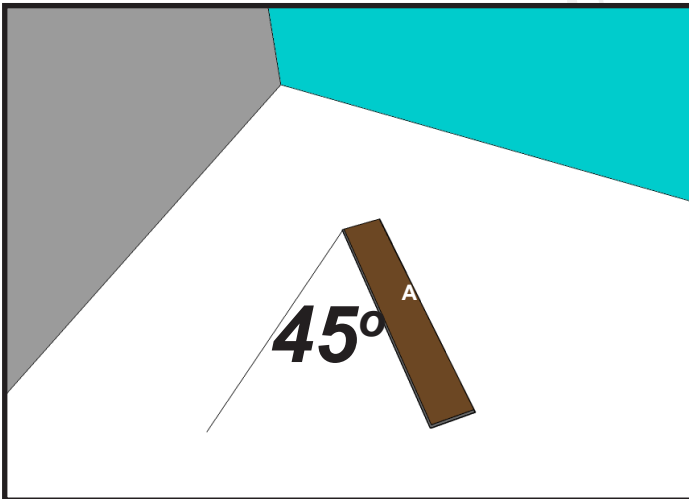

Figure 2

Step 2: Next, connect the B panel to the A panel. To do this, slightly angle the long side of the B panel against the short side of the previously installed A panel. Click the A and B panels together to lock them tightly together. Ensure it by tapping with a mallet at the joints.

Make sure that both grooves of the A and B HERF Herringbone® panels form a continuous line.

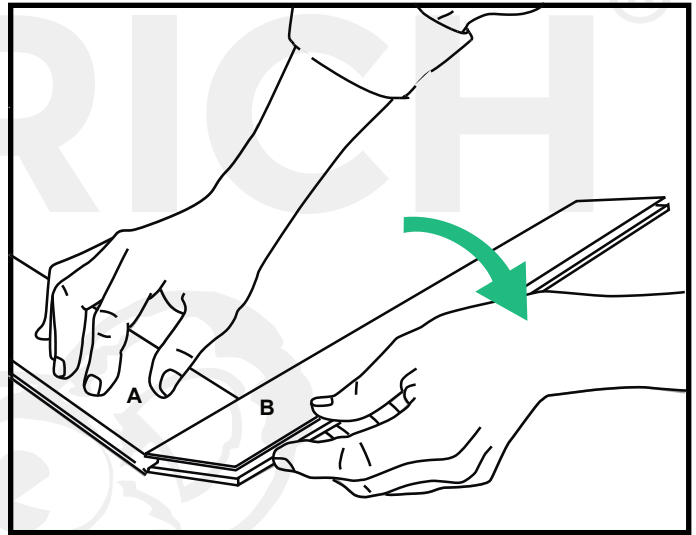

Figure 3

Step 3: Make a row of this pattern starting with the long side of the A panel clicked together with the short side of the previously installed B panel (**Figure 4**). Continue this process with as many panels as may fit along the starting wall.

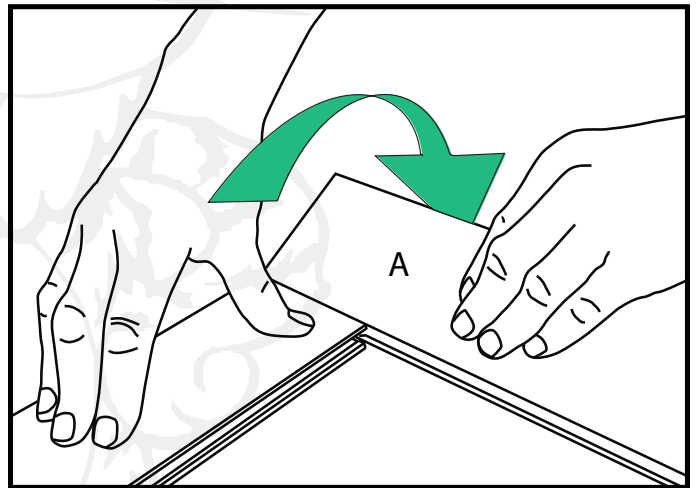

Figure 4

Step 4: Center the first wall row of HERF Herringbone® panels along the starting wall (blue walls).

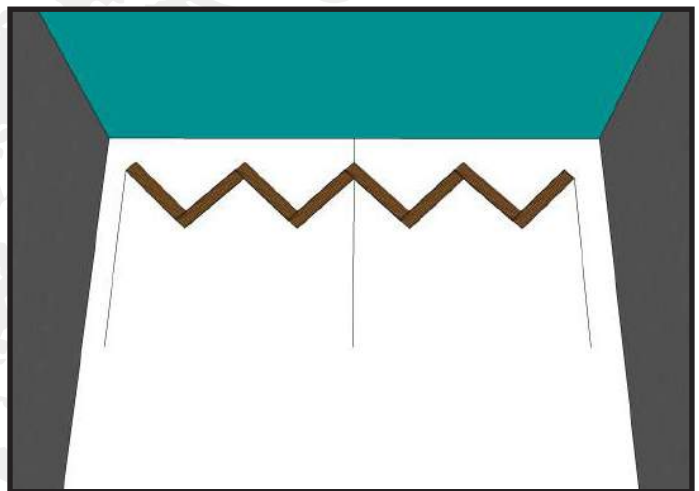

Figure 5

The distance of the first and last panels to both sides of the wall must be less than the length of one panel.

Step 5: Measure and cut the end panels using a pen knife but leave a gap of 3-5mm to each wall to allow space for expansion.

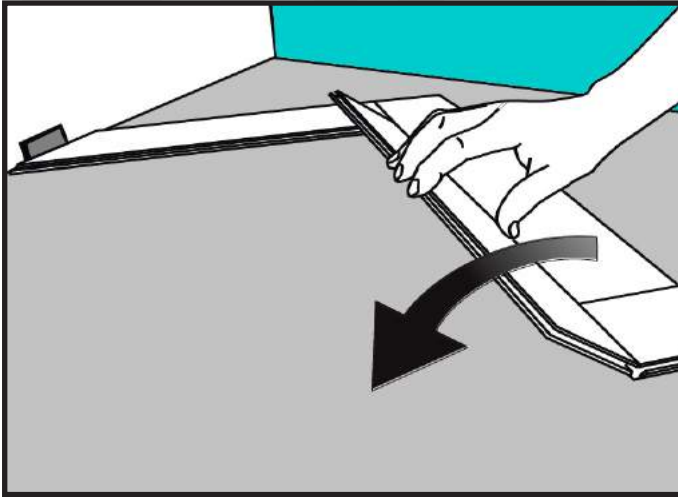

Figure 6

Next, begin the second row with an A panel. Click together and fold down to secure the connection (**Figure 6**).

Step 6: From left to right, continue installing the A panels in the second row (**Figure 7**).

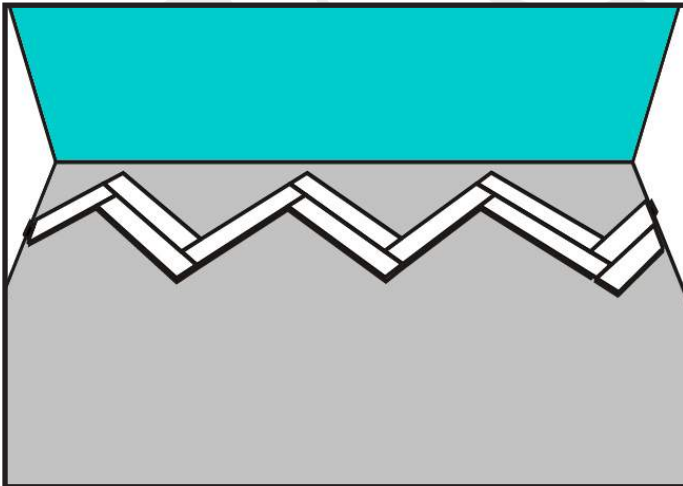

Figure 7

Step 7: From right to left, finish the second row by clicking the B panels together. Finish this row by cutting a piece of panel cut to size (**Step 5**).

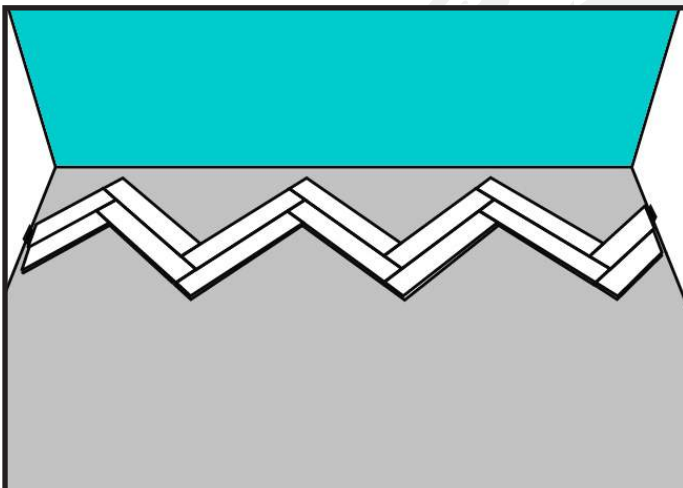

Figure 8

Step 8: Complete 4 rows by repeating steps 5 to 7. Measure, mark, and then cut the first four rows to achieve a cut parallel to the blue wall (**Figure 9**).

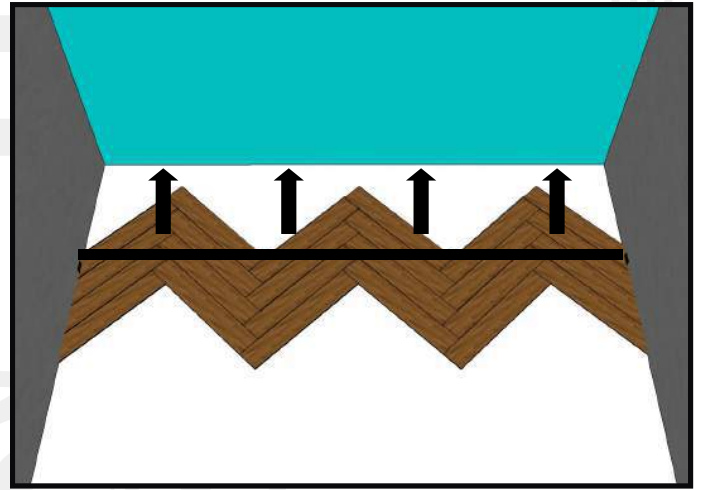

Figure 9

Step 9: Install a few more rows by following steps 5 to 7. Put in spacers between the HERF Herringbone® panels and walls to ensure an expansion gap of 3 to 5mm (**Figure 10**).

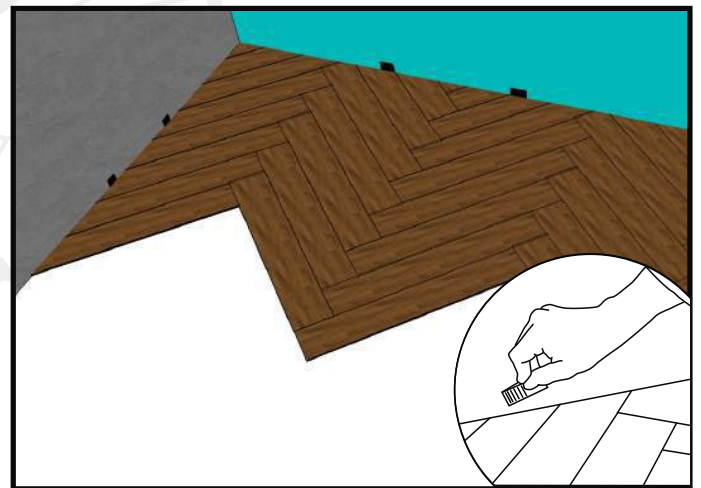

Figure 10

Step 10: For the last row, measure, mark, and then cut the panels to size. Remove spacers and cover the expansion gaps with skirting boards and/or trimmings OR use silicone to fill up the gaps for a skirting-free finish.

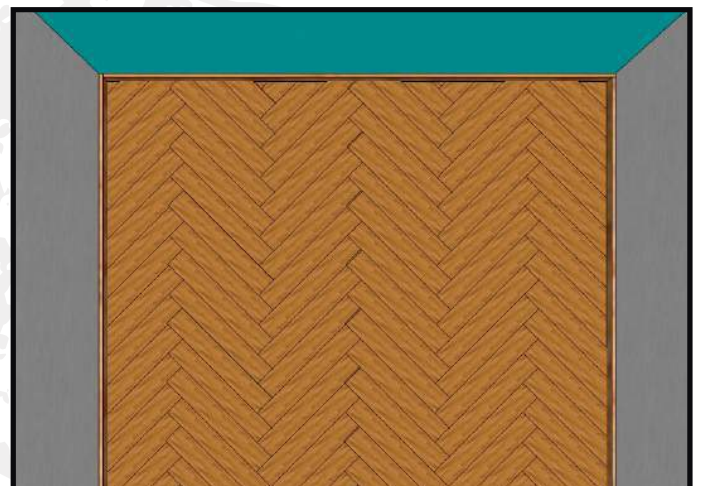

Figure 11

CAUTION AND MISCELLANEOUS

If you have any problems or questions, please call our Customer Help Line at: +65 6348 7333

Are you getting the idea that this product was created by people who love their job? Well, the answer to that question is "YES, WE DO!" and we will continue to enhance HERF Herringbone® experience with added installation features as well as innovative products and exciting patterns that meet the needs of our customers.

Thank you for buying HERF Herringbone®, and be sure to share with us your experience in using the product. Simply write or email to:

Evorich Global Support:

16 Tampines Street 92
Singapore 528873
feedback@evorich.com.sg



EVORICH®



Evorich Manufacturing Pte Ltd

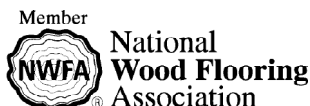

EYA-Established Entrepreneur 2016



w: www.EVORICH.com.sg | e: sales@evorich.com.sg

T: +65 6348 7333 | F: +65 6342 9331

Evorich R&D Building & Gallery (Cheques Receiving Centre): 16 Tampines Street 92 Singapore 528873

Evorich Floors, Deck, Wall Academy: 27 Kim Chuan Terrace Singapore 537045

Evorich Eco Flooring Design Studio: KidZania Singapore at Sentosa Island